

4

3

2

1

NOTES

- 1. VACUUM COMPATIBLE UP TO 10^{-8} TORR
- 2. MAX OPERATING TEMP.: 300°C
- 3. ALL RTDs (ITEM 2) ARE POTTED AS SHOWN USING BCE EPOXY (ITEM 3) MEETING NASA'S LOW OUTGASSING SPEC ASTM E595
- 4. RTD SPECS (ITEM 2):
 - A. 100Ω AT 0°C, .00385 COEF. CLASS B 0.12%, DUAL WIRE
 - B. PROBE IS BRAZED TO SHIM
 - C. 2X 26 AWG KAPTON INSULATED WIRE, BARE END, CRIMPED
- 5. HEATER SPECS (ITEM 4):
 - A. 500W, 240V
 - B. WIRE TYPE: Ni-Cr 80/20
 - C. LEAD TYPE: RIGID Ni, FIBERGLASS INSULATION, TEFLON SLEEVE
 - D. 321 SS SHEATH
 - E. BUILT-IN THERMOCOUPLE TYPE J, TEFLON INSULATION
- 6. ALL MATERIALS, DIMENSIONS AND COMPONENTS ARE CUSTOMIZABLE

CAN BE ENGINEERED FOR ANY APPLICATION. PROVIDES PRECISE HEATING AND TEMPERATURE MONITORING FOR VACUUM APPLICATIONS.

B

B

VACUUM SIDE

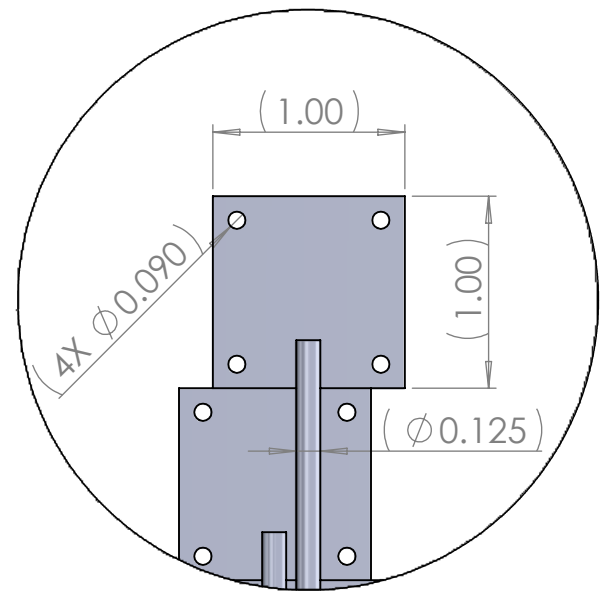
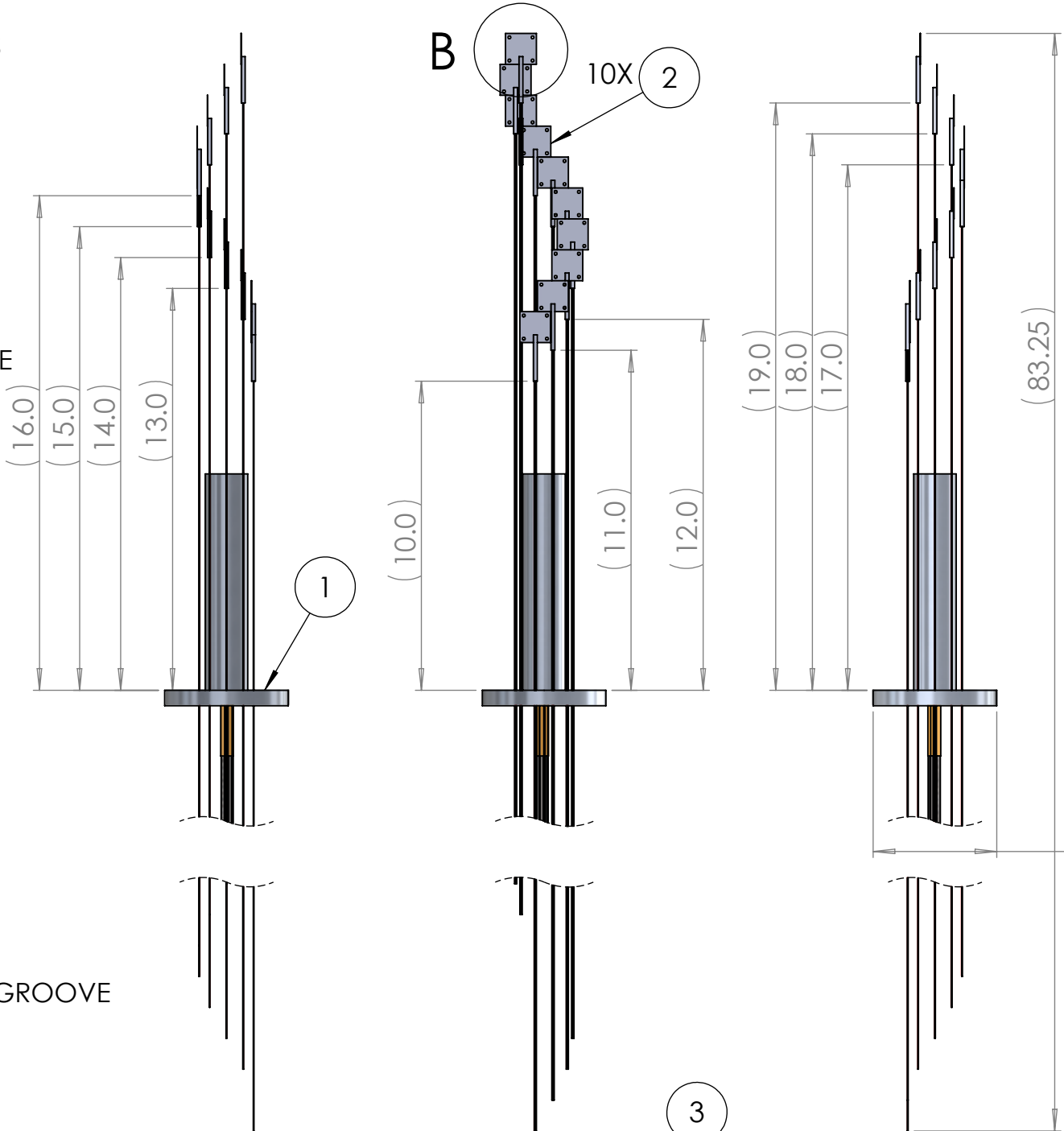
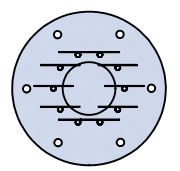

DETAIL B
SCALE NTS
.01 THK

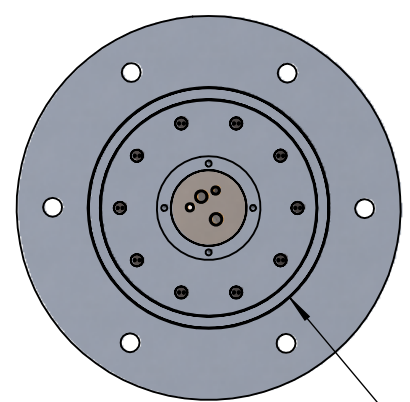

DETAIL A
SCALE NTS
DOVETAIL O-RING GROOVE

ATMOSPHERE SIDE

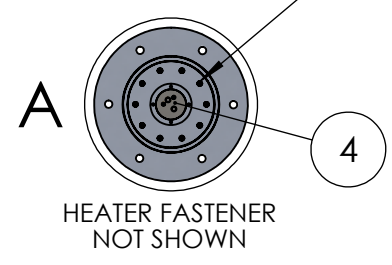

HEATER FASTENER
NOT SHOWN

ITEM NO.	PART NUMBER	DESCRIPTION	QTY.
1	BCE10042	AL 6061 VACUUM THERMOWELL	1
2	BCE10050	SHIM STYLE RTD	10
3	/EPOXY	BCE EPOXY SEAL	1
4	BCE10070	CARTRIDGE HEATER	1

UNLESS OTHERWISE SPECIFIED:
 DIMENSIONS ARE IN INCHES
 TOLERANCES:
 FRACTIONAL ±
 ONE PLACE DECIMAL ±.125
 TWO PLACE DECIMAL ±.010
 THREE PLACE DECIMAL ±.005



TITLE:
VACUUM THERMOWELL ASSY

PROPRIETARY AND CONFIDENTIAL
 THE INFORMATION CONTAINED IN THIS DRAWING IS THE SOLE PROPERTY OF BCE INC. ANY REPRODUCTION IN PART OR AS A WHOLE WITHOUT THE WRITTEN PERMISSION OF BCE INC. IS PROHIBITED.

INTERPRET GEOMETRIC TOLERANCING PER:
 MATERIAL SEE BOM
 FINISH -
 DO NOT SCALE DRAWING

SIZE	DWG. NO.	REV
B	BCE10069	A
SCALE: NTS	WEIGHT: -	SHEET 1 OF 1

4

3

2

1

A

A